

## Open Day Program – Coffs Harbour Panel Sessions

Panel Session	Time	Venue
Get to Know Southern Cross	10.00am – 10.25am	Clinical Sciences (U.G.10)
Pathways to university	10.30am – 10.55am	Clinical Sciences (U.G.10)
Science: Marine and Environment	10.30am – 10.55am	High Performance Lab (U.G.18)
Occupational Therapy	11.00am – 11.25am	Clinical Sciences (U.G.10)
Education and Teaching	11.00am- 11.25am	High Performance Lab (U.G.18)
Nursing	12.00pm – 12.25pm	Clinical Sciences (U.G.10)
Social Work and Community Welfare	12.00pm – 12.25pm	High Performance Lab (U.G.18)
Psychology and Counselling	12.30pm – 12.55pm	Clinical Sciences (U.G.10)
Midwifery	12.30pm – 12.55pm	High Performance Lab (U.G.18)
Speech Pathology	1.00pm – 1.25pm	Clinical Sciences (U.G.10)
Sport, Exercise Science and Exercise Physiology	1.00pm – 1.25pm	High Performance Lab (U.G.18)

## Open Day Program – Coffs Harbour Faculty Experiences

Faculty Experience	Time	Venue
National Marine Science Centre Tour	11.15am – 12.30pm	Meet at Bus Bay next to F Block
Demystifying studying at university	12.00pm – 12.25pm	Block U 1.16
Nursing Workshop	12.45pm – 1.20pm	Block U 1.07
Midwifery Workshop	1.00pm – 1.25pm	Block U 1.04
Sport and Exercise Science	1.30pm – 2.00pm	Block U G.07



Southern Cross University

# Open Day

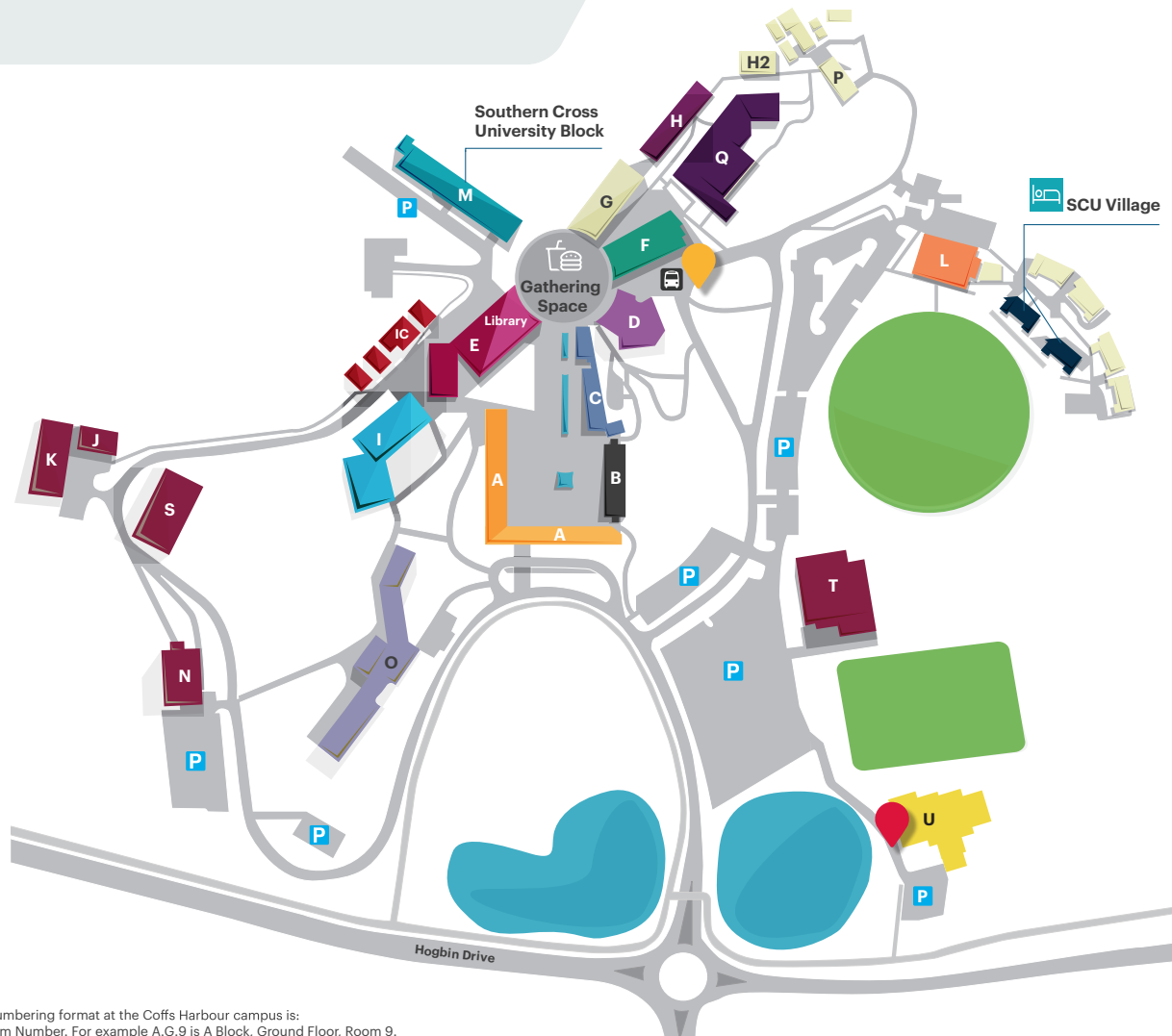
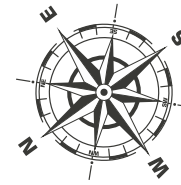

## Coffs Harbour campus

- **A Block**  
Head of Campus; Campus Security; general teaching spaces; education teaching rooms; student computer labs;
- **B Block**  
General learning spaces
- **C Block**  
SCU College; general learning spaces
- **D Block**  
Lecture theatre D.150 and D.350
- **E Block**  
General learning spaces
- **F Block**  
Student Health & Support Services; Career Development Service; Coffs Harbour Students' Association; cafeteria; University Lounge; coffee shop; EFTPOS facility
- **Gathering Space**  
Outdoor common area adjacent to the D block lecture theatre and food outlets
- **SCU Village**  
Accommodation services; Carina College
- \* Other buildings
- P **Parking**
- Bus stop**
- **H Block**  
Nursing anatomy laboratory
- **I Block**  
Osprey Restaurant
- **IC**  
Coffs Harbour Innovation Centre
- **L Block**  
Multi-purpose centre
- **O Block**  
Lecture theatre; general learning spaces
- **Q Block**  
Nurse education – clinical nursing; laboratories
- **T Block**  
Teaching Gym / Coffs Harbour Gym
- **U Block**  
Health Sciences Building – health laboratories
- **Southern Cross University – M Block**  
Student Administration Services; Shared Services Hub; Academic Skills Development; University Advocacy Support; IASS (Indigenous Australian Student Services); AIME (Australian Indigenous Mentoring Experience); Southern Cross Postgraduate Association; midwifery lab; sport and exercise science lab; psychology labs; School of Arts and Social Sciences; School of Business and Tourism; School of Education; School of Health and Human Sciences; SCU International; Equity and Diversity; Chaplaincy

● **Marine Science Tour meeting point**  
Bus Bay (Outside F-Block)  
Departing 11:15am–12:30pm

● **Campus tour meeting point**  
U-Block entrance  
Campus tours depart every 30 minutes between 10:00am–1:00pm.

**Note:** The room numbering format at the Coffs Harbour campus is: Block / Floor / Room Number. For example A.G.9 is A Block, Ground Floor, Room 9.



Scan to view digital map



Scan to view program guide