



EXPRESSION OF INTEREST

HOSPITALITY OPPORTUNITY LISMORE CAMPUS

EOI Opens: 27 February 2024

Deadline for questions: 8 March 2024

EOI Closes: 15 March 2024



**Southern Cross
University**

CONTENTS

- About Us
- The Opportunity.
- Response Criteria

Criteria 1: Vision

Criteria 2: Track Record & Ambition

Criteria 3: Success Needs

- Floor Plan



ABOUT US

Southern Cross University is a vibrant regional university.

Our Northern Rivers campus at Military Road, East Lismore, has 75 hectares of lush rainforest.

The campus is home to more than 1,000 students, 300 staff members, a high school, a primary school and a branch of TAFE NSW, a popular gym and fitness facility, and an indoor swimming pool.

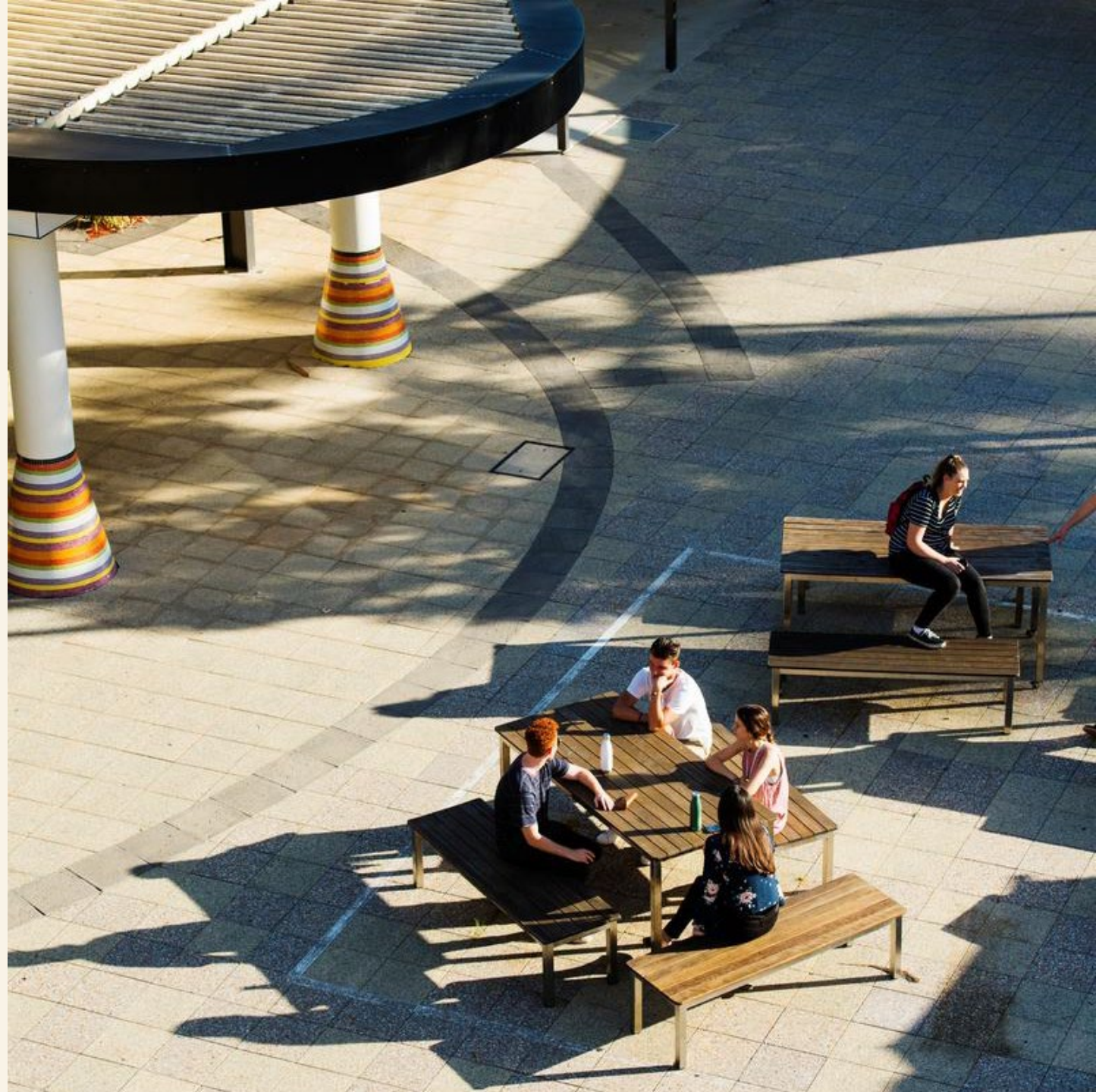



THE OPPORTUNITY

Southern Cross University seeks to provide an opportunity for a suitable vendor to operate their own hospitality business out of the former Deck and Lounge space in J block at the Lismore Campus.

We have up to 172 square metres available, including a bar area and a commercial kitchen, suitable for various styles of business operations.

We are keen to see the space back up and running as a vibrant meeting place for the community and visitors while providing sustainable commercial returns to the University.

These might include occasional or ongoing:

- Catering and event services
- 'Hole in the wall' café
- Meal preparation and a takeaway service
- Coffee and snack bar
- Music and live events

RESPONSE CRITERIA 1

Detail your vision and plan to bring the vision to reality.

It is important to us that the look, feel, and ambience of the space is inviting to a broad range of customers that ensure a seamless and positive experience while visiting the Lismore Campus.

VISION: Describe your vision and how it fits in with the different campus stakeholders. Describe the experience from a customer view point.

FOOD & BEVERAGE: Describe your food service plans including sample menus, promotions, takeaway products and dietary needs.

SUSTAINABILITY: How do you source your food and products.



RESPONSE CRITERIA 2

Detail your track record and ambition

REFERENCES: Provide two references that are less than 5 years old

HISTORY: Describe your hospitality and food experience, ability, and capacity to operate a successful business



RESPONSE CRITERIA 3

Let us know what you need from us.

ASSUMPTIONS: List any assumptions relating to the EOI.

COMMERCIALS: Tell us what you need to be successful.

SITE INSPECTION: A site inspection is mandatory to accept an EOI and can be coordinated through propertyservices@scu.edu.au

Note: Terms and conditions will be detailed in a formal agreement



FLOOR PLAN

Commercial Kitchen 141.88 m²

Bar 30.86 m²

Total 172.74 m²

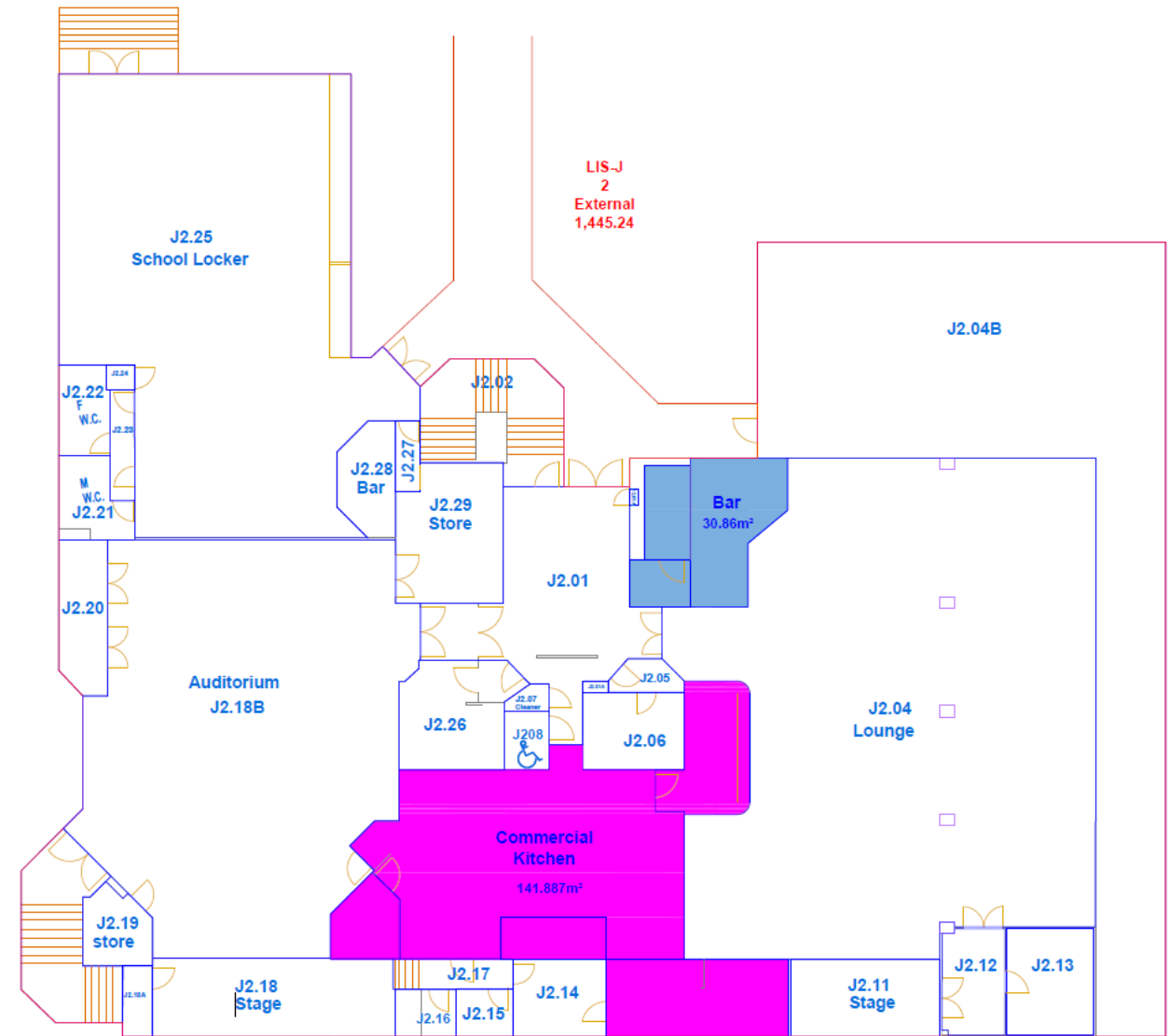



QUESTIONS

For all enquiries contact
Property Services,
propertyservices@scu.edu.au

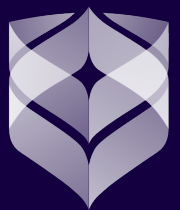

**Southern Cross
University**